

PLEASE CHECK WWW.MOLEX.COM FOR LATEST PART INFORMATION

Part Number: [0768290008](#)
Status: **Active**
Overview: Mega-Fit® Power Connectors
Description: Mega-Fit™ Vertical Header, Through Hole, 5.70mm Pitch, Dual Row, 8 Circuits, Tin, Glow Wire Capable, Black

Documents:

[3D Model](#) [Packaging Specification PK-31301-976 \(PDF\)](#)
[Drawing \(PDF\)](#) [RoHS Certificate of Compliance \(PDF\)](#)

Agency Certification

CSA LR19980
 UL E29179

General

Product Family PCB Headers
 Series [76829](#)
 Application Power, Wire-to-Board
 Overview [Mega-Fit® Power Connectors](#)
 Product Name Mega-Fit®
 UPC 887191454214

Physical

Breakaway No
 Circuits (Loaded) 8
 Circuits (maximum) 8
 Color - Resin Black
 First Mate / Last Break No
 Flammability 94V-0
 Glow-Wire Compliant Yes
 Keying to Mating Part Yes
 Lock to Mating Part Yes
 Mated Height 16.78mm
 Material - Metal Copper
 Material - Plating Mating Tin
 Material - Plating Termination Tin
 Material - Resin High Temperature Thermoplastic
 Net Weight 4.599/g
 Number of Rows 2
 Orientation Vertical
 PCB Locator Yes
 PCB Retention Yes
 PCB Thickness - Recommended 1.57mm, 2.36mm
 Packaging Type Tray
 Pitch - Mating Interface 5.70mm
 Pitch - Termination Interface 5.70mm
 Plating min - Mating 1.524µm
 Plating min - Termination 1.270µm
 Polarized to Mating Part Yes
 Polarized to PCB Yes
 Shrouded Yes
 Surface Mount Compatible (SMC) Yes
 Temperature Range - Operating -40°C to +105°C
 Termination Interface: Style Through Hole
 Unmated Height 14.03mm

Electrical

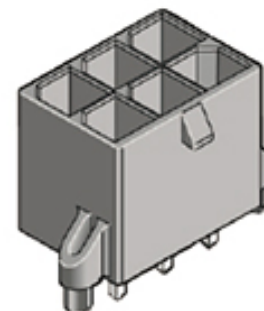

Series image - Reference only

EU ELV

Not Relevant

EU RoHS

Compliant

REACH SVHC

Not Contained Per -
 ED/21/2016 (20 June
 2016)

Halogen-Free

Status

Low-Halogen

**Need more information on product
 environmental compliance?**

Email productcompliance@molex.com
 Please visit the [Contact Us](#) section for any
 non-product compliance questions.

China ROHS

ELV

Green Image

Not Relevant

Search Parts in this Series

[76829](#) Series

Mates With

Mega-Fit® Male Crimp Housing [171692](#) ,
[170001](#)

Current - Maximum per Contact	23.0A
Voltage - Maximum	600V

Solder Process Data

Duration at Max. Process Temperature (seconds)	030
Lead-free Process Capability	SMC&WAVE
Max. Cycles at Max. Process Temperature	001
Process Temperature max. C	260

Material Info

Reference - Drawing Numbers

Packaging Specification	PK-31301-976
Sales Drawing	SD-76829-0100

This document was generated on 07/14/2016

PLEASE CHECK WWW.MOLEX.COM FOR LATEST PART INFORMATION