

Printed-circuit board connector - DFK-PC 5/ 2-G-7,62 - 1727582

Please be informed that the data shown in this PDF Document is generated from our Online Catalog. Please find the complete data in the user's documentation. Our General Terms of Use for Downloads are valid (<http://phoenixcontact.com/download>)

Header, Nominal current: 41 A, Rated voltage (III/2): 630 V, Number of positions: 2, Pitch: 7.62 mm, Color: green, Contact surface: Tin, Mounting: Wave soldering



Why buy this product

- Well-known mounting principle allows worldwide use
- Flange system enables secure fixing to the housing panel by means of tool-free snap-in locking or screws



Key Commercial Data

| | |
|--------------------------------------|---|
| Packing unit | 10 pc |
| Minimum order quantity | 10 pc |
| GTIN |  4 046356 134613 |
| Weight per Piece (excluding packing) | 9.54 g |
| Custom tariff number | 85366990 |
| Country of origin | Poland |
| Note | Made to Order (non-returnable) |

Technical data

Dimensions

| | |
|--------------------------|-----------|
| Length | 29.25 mm |
| Pitch | 7.62 mm |
| Dimension a | 7.62 mm |
| Constructional height | 19.54 mm |
| Length of the solder pin | 5 mm |
| Pin dimensions | 0,8 x 1,0 |
| Pin spacing | 7.62 mm |
| Hole diameter | 1.3 mm |

General

| | |
|-------------------|----------------|
| Range of articles | DFK-PC 5/...-G |
|-------------------|----------------|

Printed-circuit board connector - DFK-PC 5/ 2-G-7,62 - 1727582

Technical data

General

| | |
|--|--------|
| Insulating material group | I |
| Rated surge voltage (III/3) | 6 kV |
| Rated surge voltage (III/2) | 6 kV |
| Rated surge voltage (II/2) | 6 kV |
| Rated voltage (III/3) | 500 V |
| Rated voltage (III/2) | 630 V |
| Rated voltage (II/2) | 800 V |
| Connection in acc. with standard | EN-VDE |
| Nominal current I _N | 41 A |
| Maximum load current | 41 A |
| Insulating material | PA |
| Flammability rating according to UL 94 | V0 |
| Color | green |
| Number of positions | 2 |

Standards and Regulations

| | |
|--|--------|
| Connection in acc. with standard | EN-VDE |
| | CUL |
| Flammability rating according to UL 94 | V0 |

Classifications

eCl@ss

| | |
|------------|----------|
| eCl@ss 4.0 | 272607xx |
| eCl@ss 4.1 | 27260701 |
| eCl@ss 5.0 | 27260701 |
| eCl@ss 5.1 | 27141190 |
| eCl@ss 6.0 | 27260704 |
| eCl@ss 7.0 | 27440402 |
| eCl@ss 8.0 | 27440402 |
| eCl@ss 9.0 | 27440402 |

ETIM

| | |
|----------|----------|
| ETIM 3.0 | EC001121 |
| ETIM 4.0 | EC002637 |
| ETIM 5.0 | EC002637 |

UNSPSC

| | |
|---------------|----------|
| UNSPSC 6.01 | 30211810 |
| UNSPSC 7.0901 | 39121409 |
| UNSPSC 11 | 39121409 |
| UNSPSC 12.01 | 39121409 |

Printed-circuit board connector - DFK-PC 5/ 2-G-7,62 - 1727582

Classifications

UNSPSC

| | |
|-------------|----------|
| UNSPSC 13.2 | 39121409 |
|-------------|----------|

Approvals

Approvals

Approvals

UL Recognized / cUL Recognized / EAC / cULus Recognized

Ex Approvals

Approvals submitted

Approval details

| | | | |
|---|-------|-------|-------|
| UL Recognized  | | | |
| | B | C | D |
| Nominal current I _N | 41 A | 41 A | 10 A |
| Nominal voltage U _N | 300 V | 150 V | 300 V |

| | | | |
|--|-------|-------|-------|
| cUL Recognized  | | | |
| | B | C | D |
| Nominal current I _N | 41 A | 41 A | 10 A |
| Nominal voltage U _N | 300 V | 150 V | 300 V |

| |
|-----|
| EAC |
|-----|

| |
|--|
| cULus Recognized  |
|--|

Drawings

Printed-circuit board connector - DFK-PC 5/ 2-G-7,62 - 1727582

Drilling diagram

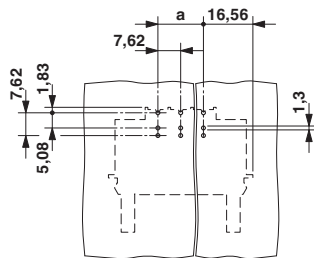

Dimensional drawing

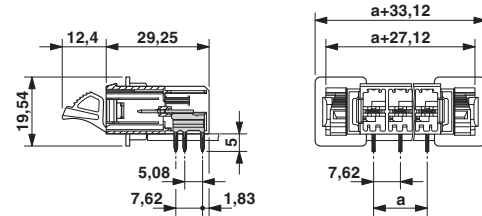

Dimensional drawing

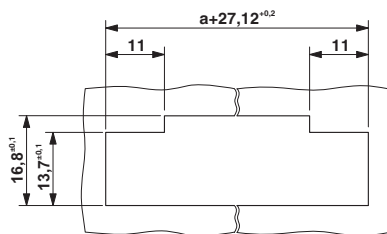

Sheet metal cutout for snap-on.

Dimensional drawing

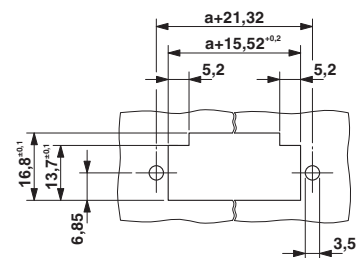

Sheet metal cutout for screw connection.